

Filtre

Filter

HCF FIBERPOOL® SERIES / FH1000
REF: HCFF HCFH

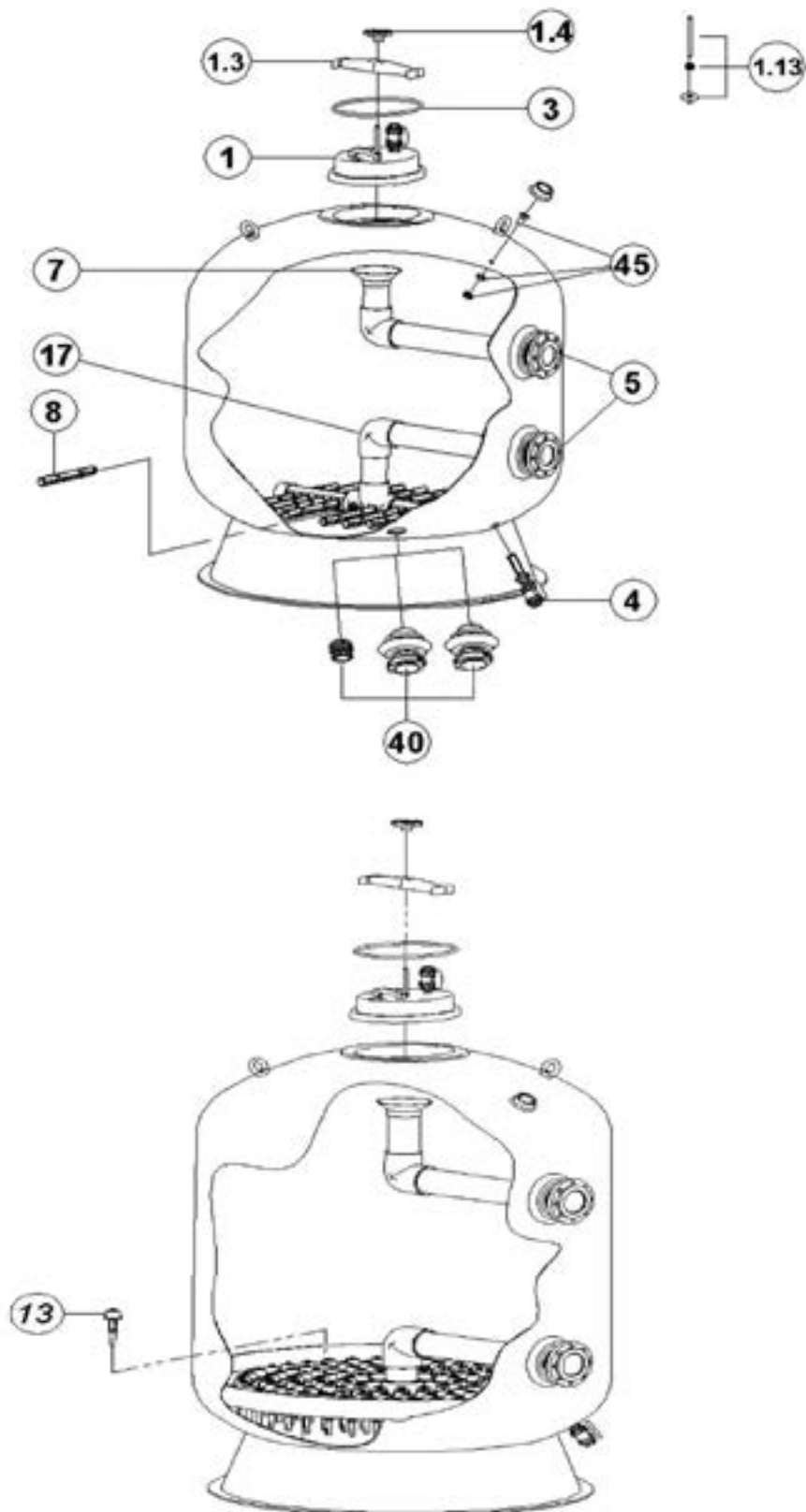

N°	DESCRIPTION ⁽¹⁾	REF./ PART No.	Qty/ Box
1 + 1.3 + 1.4 + 3	Lid • Dôme • Deckel • Domo • Coperchio • Коерпел • Tapa • Крышка	500361000103	1
1 + 1.3 + 1.4 + 3	Reinforced Lid • Dôme renforcé • Tapa reforzada	500361000104	1
1 + 1.3 + 1.4 + 3	Lid for industrial bobbin filter, 2'5 - 4 Bar up to 1998 • Dôme pour filtre industriel 2'5 - 4 Bar up to 1998 • Tapa filtro industrial bobinado hasta 1998	500360098200	1
1 + 1.3 + 1.4 + 3	Lid for industrial bobbin filter, 2'5 - 4 Bar up 1998-2006 • Dôme pour filtre industriel 2'5 - 4 bar 1998 - 2006 • Tapa filtro industrial bobinado 1998-2006	500360006200	1
1 + 1.3 + 1.4 + 3	Lid for industrial bobbin filter, 2'5 - 4 Bar 2006-2008 • Dôme pour filtre industriel 2'5 - 4 bar 2006-2008 • Tapa filtro industrial bobinado 2,5 - 4 bar 2006-2008	500360008200	1
1 + 1.3 + 1.4 + 3	Lid for industrial bobbin filter, 6 bar • Dôme pour filtre industriel 6 bar • Tapa filtro industrial bobinado 6 bar	500361000105	1
1.3	Bridge • Pont • Brücke • Puente • Ponte • Ponte • Brug • мост	500361111301	1
1.3	Bridge • Pont • Brücke • Puente • Ponte • Ponte • Brug • мост / Aluminium	500361111302	1
1.4	Threaded knob • Bouton fileté • Gewindeknopf • Pomo roscado • Manopola filettata • Botão roscado • Draaiknop • Резьбовая ручка	500311111400	1
1.13	Closing rod kit • Kit de tige de fermeture • Kit esparrago cierre	500361000113	1
3	Lid O'Ring • Joint torique de dôme • Deckel O'Ring • O'Ring de domo • Guarnizione O'ring della coperchio • Коерпел o'ring • O-Ring de Cúpula • Уплотнительное кольцо	500361000302	2
4	1"Water drain kit for industrial bobbin filter • Kit de vidange pour filtre industriel • Conjunto desague valvula 1" filtro bobinado industrial	500361000405	1
	Connection Ø63 for filter Ø 1050 • Connexion Ø63 pour filtre Ø 1050 • Salida torn.largos Ø63 p/1050	500361000501	1
	Connection Ø63 for filter 1200-1400 • Connexion Ø63 pour filtre 1200-1400 • Salida torn.largos Ø63 p/1200-1400	500361000502	1
	Connection Ø75 for filter 1050-1200 • Connexion Ø63 pour filtre 1050-1200 • Salida torn.largos Ø63 p/1050-1200	500361000503	1
	Connection Ø75 for filter 1400-1600 • Connexion Ø75 pour filtre 1400-1600 • Salida torn.largos Ø75 p/1400-1600	500361000504	1
	Connection Ø75 for filter 1800-2000 • Connexion Ø75 pour filtre 1800-2000 • Salida torn.largos Ø75 p/1800-2000	500361000505	1
	Connection Ø90 for filter 1050-1200 • Connexion Ø90 pour filtre 1050-1200 • Salida torn.largos Ø90 p/1050-1200	500361000506	1
	Connection Ø90 for filter 1400-1600 • Connexion Ø90 pour filtre 1400-1600 • Salida torn.largos Ø90 p/1400-1600	500361000507	1
	Connection Ø90 for filter 1800-2000 • Connexion Ø90 pour filtre 1800-2000 • Salida torn.largos Ø90 p/1800-2000	500361000508	1
	Connection Ø110 for filter 1400-1600 • Connexion Ø110 pour filtre 1400-1600 • Salida torn.largos Ø110 p/1400-1600	500361000509	1
5	Connection Ø110 for filter 1800-2000 • Connexion Ø110 pour filtre 1800-2000 • Salida torn.largos Ø110 p/1800-2000	500361000510	1
	Connection Ø110 for filter 2350-2500 • Connexion Ø110 pour filtre 2350-2500 • Salida torn.largos Ø110 p/2350-2500	500361000511	1
	Connection Ø125 for filter 1400-1600 • Connexion Ø125 pour filtre 1400-1600 • Salida torn.largos Ø125 p/1400-1600	500361000512	1
	Connection Ø125 for filter 1800-2000 • Connexion Ø125 pour filtre 1800-2000 • Salida torn.largos Ø125 p/1800-2000	500361000513	1
	Connection Ø125 for filter 2350-2500 • Connexion Ø125 pour filtre 2350-2500 • Salida torn.largos Ø125 p/2350-2500	500361000514	1
	Connection Ø140 for filter 1800-2000 • Connexion Ø140 pour filtre 1800-2000 • Salida torn.largos Ø140 p/1800-2000	500361000515	1
	Connection Ø140 for filter 2350-2500 • Connexion Ø140 pour filtre 2350-2500 • Salida torn.largos Ø140 p/2350-2500	500361000516	1
	Connection Ø160 for filter 1800-2000 • Connexion Ø160 pour filtre 1800-2000 • Salida torn.largos Ø160 p/1800-2000	500361000517	1
	Connection Ø160 for filter 2350-2500 • Connexion Ø160 pour filtre 2350-2500 • Salida torn.largos Ø160 p/2350-2500	500361000518	1

(1) Description / Description / Bezeichnung / Descripción / Descrizione / Beschrijving / Descrição / Описание

N°	DESCRIPTION ⁽¹⁾	REF./ PART No.	Qty/ Box
7	Diffuser • Diffuseur supérieur • Verteiler • Difusor • Diffusore • Verdeler • Retire o difusor • Диффузор		
	Ø 63 mm	500200070200	1
	Ø 75 mm	500321000701	1
	Ø 90 mm	500321000702	1
	Ø 110 mm	500321000703	1
	Ø 125 mm	500321000704	1
	Ø 140 mm	500321000705	1
	Ø 160 mm	500321000706	1
8	Lateral • Crépine • Verteiler • Crepina • Candeletta • Draadfilters • Ralos • Сепаратор		
	L=170 mm	500201151000	2
	L=210 mm	500321000803	2
	L=270 mm	500201111000	2
	L=320 mm	500201121000	2
	L=380 mm	500201131000	2
	L=420 mm	500201171000	2
	L=540 mm	500201141000	2
8	PVC Lateral (OZONE) • Crépine • Verteiler • Crepina • Candeletta • Draadfilters • Ralos • Сепаратор		
	L=130 mm	500321000850	2
	L=195 mm	500321000851	2
	L=240 mm	500321000852	2
	L=300 mm	500321000853	2
	L=350 mm	500321000854	2
	L=415 mm	500321000855	2
	L=465 mm	500321000856	2
13	Nozzle lenght 140 mm (40 x 0,2 mm) • Longueur Crépine 140 mm (40 x 0,2 mm) • Crepina longitud 140 mm (40 x 0,2 mm)	500311001302	2
17	Complete arm collector Ø1050-63 • Colector completo Ø1050-63	500361171006	1
	Complete arm collector Ø1050-75 • Colector completo Ø1050-75	500361171007	1
	Complete arm collector Ø1050-90 • Colector completo Ø1050-90	500361171009	1
	Complete arm collector Ø1200-63 • Colector completo Ø1200-63	500361171206	1
	Complete arm collector Ø1200-75 • Colector completo Ø1200-75	500361171207	1
	Complete arm collector Ø1200-90 • Colector completo Ø1200-90	500361171209	1
	Complete arm collector Ø1400-63 • Colector completo Ø1400-63	500361171406	1
	Complete arm collector Ø1400-75 • Colector completo Ø1400-75	500361171407	1
	Complete arm collector Ø1400-90 • Colector completo Ø1400-90	500361171409	1
	Complete arm collector Ø1400-110 • Colector completo Ø1400-110	500361171411	1
	Complete arm collector Ø1600-75 • Colector completo Ø1600-75	500361171607	1
	Complete arm collector Ø1600-90 • Colector completo Ø1600-90	500361171609	1
	Complete arm collector Ø1600-110 • Colector completo Ø1600-110	500361171611	1

Complete set for bobbin filters previous to 01/01/2001.Ensemble complet pour filtre bobinnés avant 2001. Para montajes anteriores a 01/01/2001, se suministrarán colectores completos.

Nº	DESCRIPTION ⁽¹⁾	REF./ PART No.	Qty/ Box
	Complete arm collector Ø1600-125 • Colector completo Ø1600-125	500361171612	1
	Complete arm collector Ø1800-75 • Colector completo Ø1800-75	500361171807	1
	Complete arm collector Ø1800-90 • Colector completo Ø1800-90	500361171809	1
	Complete arm collector Ø1800-110 • Colector completo Ø1800-110	500361171811	1
	Complete arm collector Ø1800-125 • Colector completo Ø1800-125	500361171812	1
	Complete arm collector Ø1800-140 • Colector completo Ø1800-140	500361171814	1
	Complete arm collector Ø2000-90 • Colector completo Ø2000-90	500361172009	1
	Complete arm collector Ø2000-110 • Colector completo Ø2000-110	500361172011	1
	Complete arm collector Ø2000-125 • Colector completo Ø2000-125	500361172012	1
	Complete arm collector Ø2000-140 • Colector completo Ø2000-140	500361172014	1
	Complete arm collector Ø2000-160 • Colector completo Ø2000-160	500361172016	1
	Complete arm collector Ø2200-110 • Colector completo Ø2200-110	500361172211	1
	Complete arm collector Ø2200-125 • Colector completo Ø2200-125	500361172212	1
	Complete arm collector Ø2200-140 • Colector completo Ø2200-140	500361172214	1
	Complete arm collector Ø2200-160 • Colector completo Ø2200-160	500361172216	1
17	Complete arm collector Ø2200-200 • Colector completo Ø2200-200	500361172220	1
	Complete arm collector Ø2350-110 • Colector completo Ø2350-110	500361172311	1
	Complete arm collector Ø2350-125 • Colector completo Ø2350-125	500361172312	1
	Complete arm collector Ø2350-140 • Colector completo Ø2350-140	500361172314	1
	Complete arm collector Ø2350-160 • Colector completo Ø2350-160	500361172316	1
	Complete arm collector Ø2350-200 • Colector completo Ø2350-200	500361172320	1
	Complete arm collector Ø2500-125 • Colector completo Ø2500-125	500361172512	1
	Complete arm collector Ø2500-140 • Colector completo Ø2500-140	500361172514	1
	Complete arm collector Ø2500-160 • Colector completo Ø2500-160	500361172516	1
	Complete arm collector Ø2500-200 • Colector completo Ø2500-200	500361172520	1
	Complete arm collector Ø2500-225 • Colector completo Ø2500-225	500361172522	1
	Complete arm collector Ø3000-140 • Colector completo Ø3000-140	500361173014	1
	Complete arm collector Ø3000-160 • Colector completo Ø3000-160	500361173016	1
	Complete arm collector Ø3000-200 • Colector completo Ø3000-200	500361173020	1
	Complete arm collector Ø3000-225 • Colector completo Ø3000-225	500361173022	1
	Complete arm collector Ø3000-250 • Colector completo Ø3000-250	500361173025	1
All set collectors will be shipped as standard packaged unassembled - mixed unassembled, according structure. Todos los conjuntos colectores se enviarán desmontados - semi montados, dependiendo de su estructura			
40	Sand drain kit Ø 1050-1600 • Kit de descarga de arena Ø1050-1600	500361004000	1
40	Sand drain kit Ø 1800-2000 • Kit de descarga de arena Ø1800-2000	500361004001	1
40	Sand drain kit Ø 2350-3000 • Kit de descarga de arena Ø2350-3000	500361004002	1
45	Tank adapter for pressure gauge commercial filters. (Witness gauge pressure not available as spare part.) • Kit pasamuros manómetro filtros industriales. (Manómetro de presión no disponible como recambio).	500361004500	1
-	Lid horizontal filter (reinforced) • Rapa filtro horizontal (reforzada).	500361000108	1
-	Ø90 Sight glass for bobbin filters • mirilla Ø90 para filtros bobinados Ø1050-1200	500361000912	1
-	Ø90 Sight glass for bobbin filters • mirilla Ø90 para filtros bobinados Ø1400	500361000914	1
-	Ø125 Sight glass for bobbin filters • mirilla Ø125 para filtros bobinados Ø1600	500361001216	1
-	Ø125 Sight glass for bobbin filters • mirilla Ø125 para filtros bobinados Ø1800-2000	500361001220	1
-	Ø125 Sight glass for bobbin filters • mirilla Ø125 para filtros bobinados Ø2350-2500	500361001225	1